

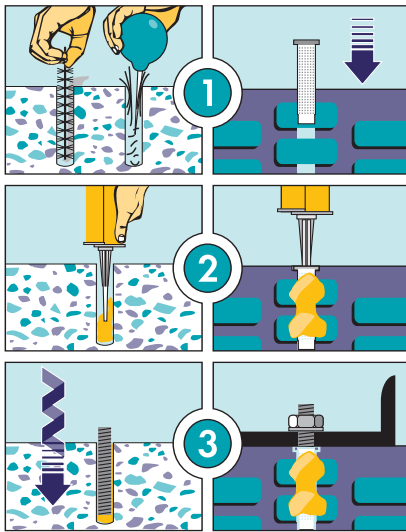

TEKAFIKS

VE 2 anchor adhesive



Two-component vinyl-ester adhesive without styrene used for anchoring under predominantly static loads

PROPERTIES

- Fast hardening
- Useful also at low temperatures, up to -10°C
- Multipurpose, for extra heavy loads
- Good adhesion to moist surfaces
- Suitable for materials being constantly under water
- Could be applied using an ordinary cartridge adhesive gun
- Does not slump on vertical surfaces
- Does not drip; over-the-head use possible
- Solvents and styrene free
- Resistant to temperatures up to 80°C, for a shorter period to 120°C
- Application temperature from +5°C to +25°C
- Makes a water resistant barrier
- Excellent adhesion to all construction materials

TECHNICAL DATA

Uncured adhesive

Hardening mechanism
Appearance

chemical reaction
Component A - white paste
Component B - black paste
Mixture - grey paste
Compound 1660 ± 10 kg/m³

Specific gravity

Bonding/hardening time

Application temperature	Bonding time	Hardening time
-5°C	90 min	360 min
0°C	45 min	180 min
5°C	25 min	120 min
10°C	15 min	80 min
20°C	6 min	45 min
30°C	4 min	25 min
35°C	2 min	20 min

Hardened adhesive

Compression strength EN 196 part 1 (94.80) MPa
Bending strength EN 196 part 1 (32.20) MPa

AREAS OF APPLICATION

- For fastening anchors supporting heavy and normal loads in stone, concrete, lightweight concrete and in bricks.
- For heavy loads and materials being constantly under water (ports, tunnels).
- Used as sanitation mortar or adhesive for concrete components.
- Used as adhesive for façade components, wooden and metal constructions, brackets, fences, sanitary implements, pipes.
- The adhesive does not expand during hardening and is thus appropriate for loads placed near facilities' edges.

TEKAFIKS VE 2 anchor adhesive



INSTRUCTIONS FOR USE

Surface preparation

Mortar and concrete must be older than 28 days. The borehole should be dry, oil free and thoroughly cleaned with a brush and compressed air.

Borehole dimensioning for anchors

Anchor	M8	M10	M12	M16	M20
Anchor diameter	8	10	12	16	20
Borehole diameter	10	12	14	18	22
Borehole depth	80	90	110	125	170
Minimum part thickness	130	140	160	175	220
Minimum distance from the edge	40	50	60	70	90
Minimum distance between anchors	80	90	110	125	170
Recommended load in concrete C20/25 (kN)	6.3	9.9	13.9	19.8	29.6

Anchor installation into massive materials like stone or concrete

- Drill correct diameter hole to recommended depth perpendicular to the surface.
- Clean the borehole thoroughly with a round brush having a diameter bigger than that of a borehole and blow the dust out of the borehole using compressed air.
- Pull the cap out of the cartridge, cut it off and attach a static mixer.
- Attach the cartridge onto a gun and start injecting the adhesive. The adhesive is well mixed when evenly grey in colour. Do not use first 10 cm of the adhesive for anchoring.
- Use bottom-up approach when filling up the borehole
- While turning the anchor slowly place it into the filled up borehole. The adhesive should come out at the side. Pay attention to insert the anchor prior to the end of bonding time.
- During hardening time the anchor cannot be moved or under load.

Anchor installation into hollow bricks

- Make a borehole.
- Clean the borehole thoroughly with a round brush having a diameter bigger than that of a borehole and blow the dust out of the borehole using compressed air.
- Insert perforated casing.
- Pull the cap out of the cartridge, cut it off and attach a static mixer.
- Attach the cartridge onto a gun and start injecting the adhesive. The adhesive is well mixed when evenly grey in colour. Do not use first 10 cm of the adhesive for anchoring.
- Use bottom-up approach when filling up the borehole.
- While turning the anchor slowly place it into the filled up borehole. The adhesive should come out at the side. Pay attention to insert the anchor prior to the end of bonding time.
- During hardening time the anchor cannot be moved or loaded.

PACKAGING

- Cartridges of 300 ml, 12 cartridges in a cardboard box

STORAGE

18 months in a dry, cold place at a temperature up to 25°C

SAFETY PRECAUTIONS

Keep out of reach of children. Wear suitable protective clothing, gloves and eye / face protection. In case of contact with eyes rinse with water and seek medical assistance. If swallowed, seek medical advice immediately and show this packaging or label.

WARNING

Instructions are given on the basis of examinations and technical experience of the firm. Due to specific conditions and work methods, preliminary tests are advised for every type of use.